

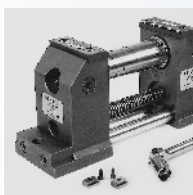

GENIUS & SinterGrip

5.4

Precision vise for
5 axis machine tools



GENIUS & SinterGrip

Page 5.4.5

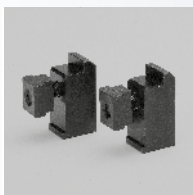

GENIUS

Accessories

Page 5.4.6



GENIUS

Spare parts

Page 5.4.10

"GENIUS" & SinterGrip

MAIN FEATURES

1

The clamping force (up to 40 kN) is generated right where it is needed: at the part.

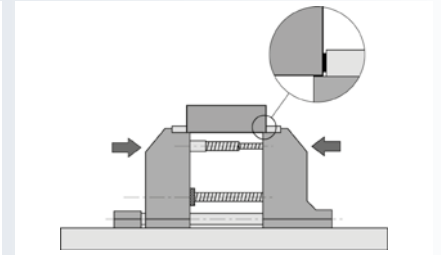
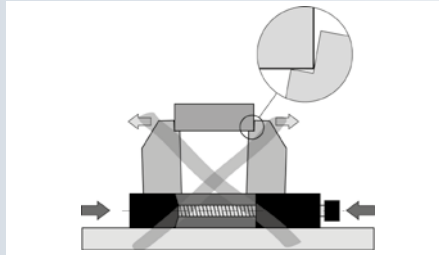

2

Thanks to its own expanding screw, GENIUS can clamp workpieces up to 200 mm with just one set-up.

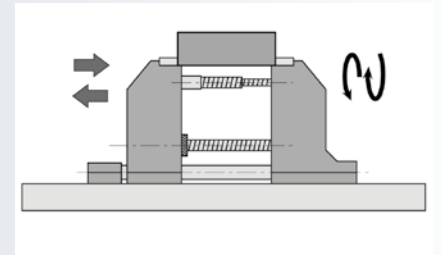

3

Unlike traditional vises, GENIUS clamps the workpieces by means of traction clamping.

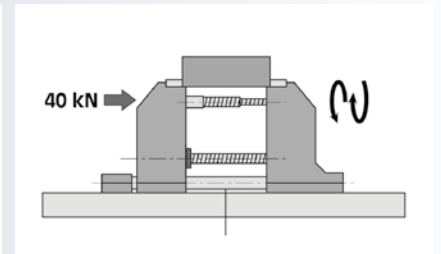
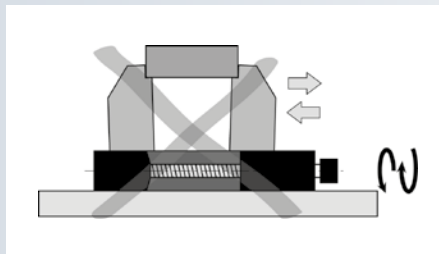

4

GENIUS is the first vise designed for 5 axis-machine tools that can be used for high precision milling operations.

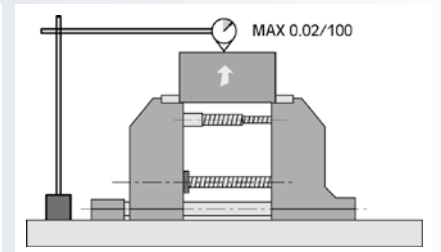
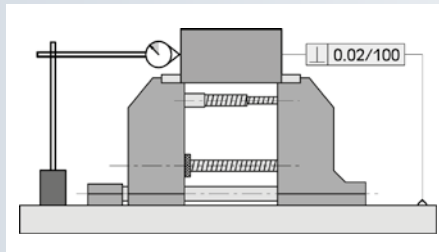

5

The movement of the jaws is not on a base, but on hardened and ground shafts. This allows for quicker and more accurate positioning of both the same axis with the centre of the machine tool pallet.

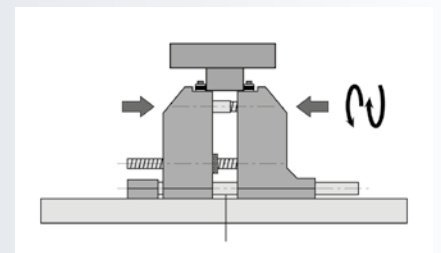

"GENIUS" & SinterGrip

5.4

Precision vise for 5 axis machine tools

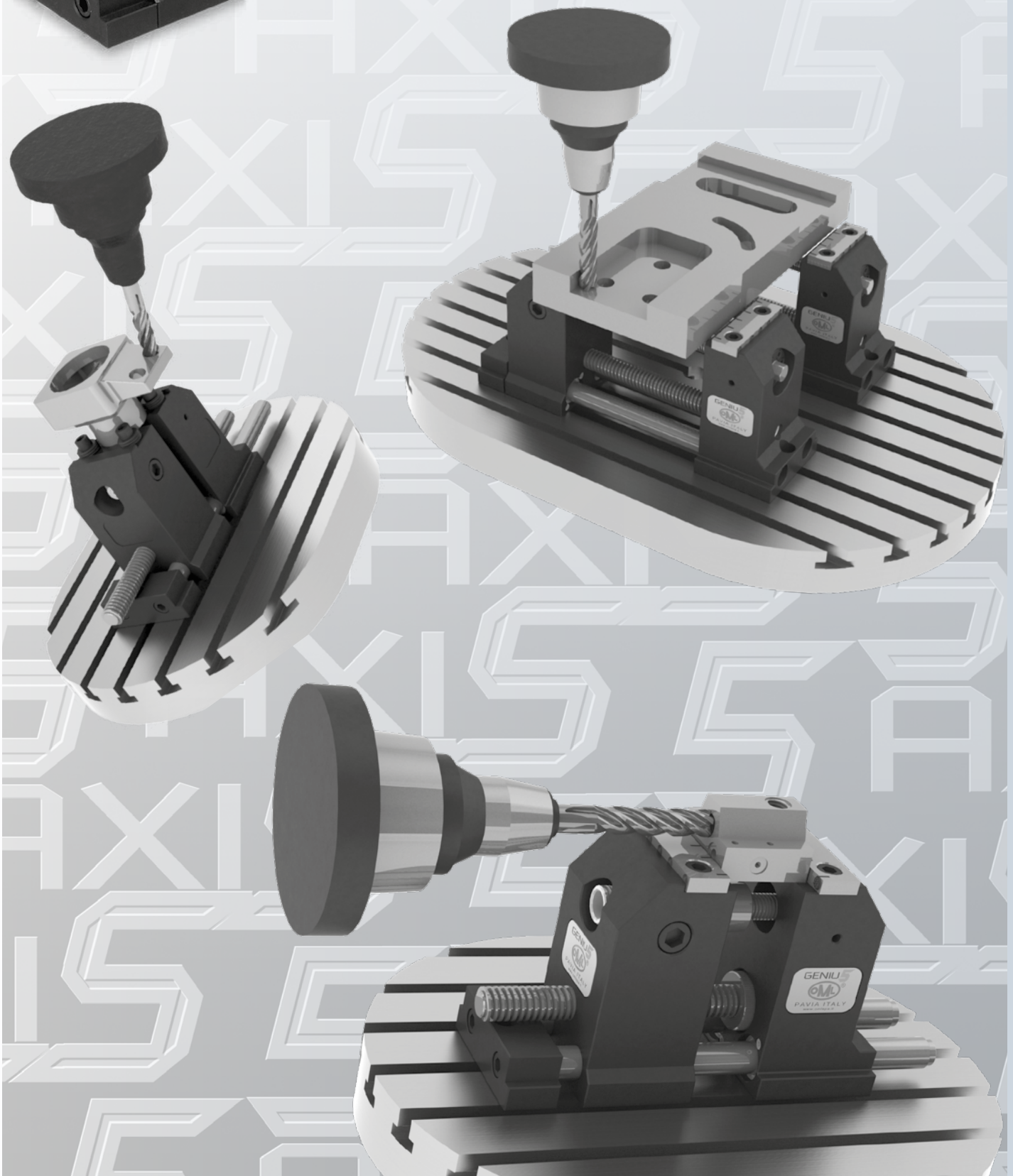

SinterGrip

Our new patented product **SinterGrip** is born to satisfy the current need to clamp a workpiece for very few millimeters (with SinterGrip 3,5 mm clamping surface), and this for the following reasons:

- 1) In order to machine the workpiece completely in a single operation (especially for 5 axis machines);
- 2) In order to save money for the raw materials, especially when they have a big impact on the price (aluminum, titanium, etc.)

Indirectly to these reasons, and in order to improve the performance of the machine tool and the tools

**higher cutting speed + higher feed rate =
bigger volume of metal removed =
less time to machine the workpiece**

the market requires safe clamping, which could at the same time possibly avoid the deformations of the piece itself.

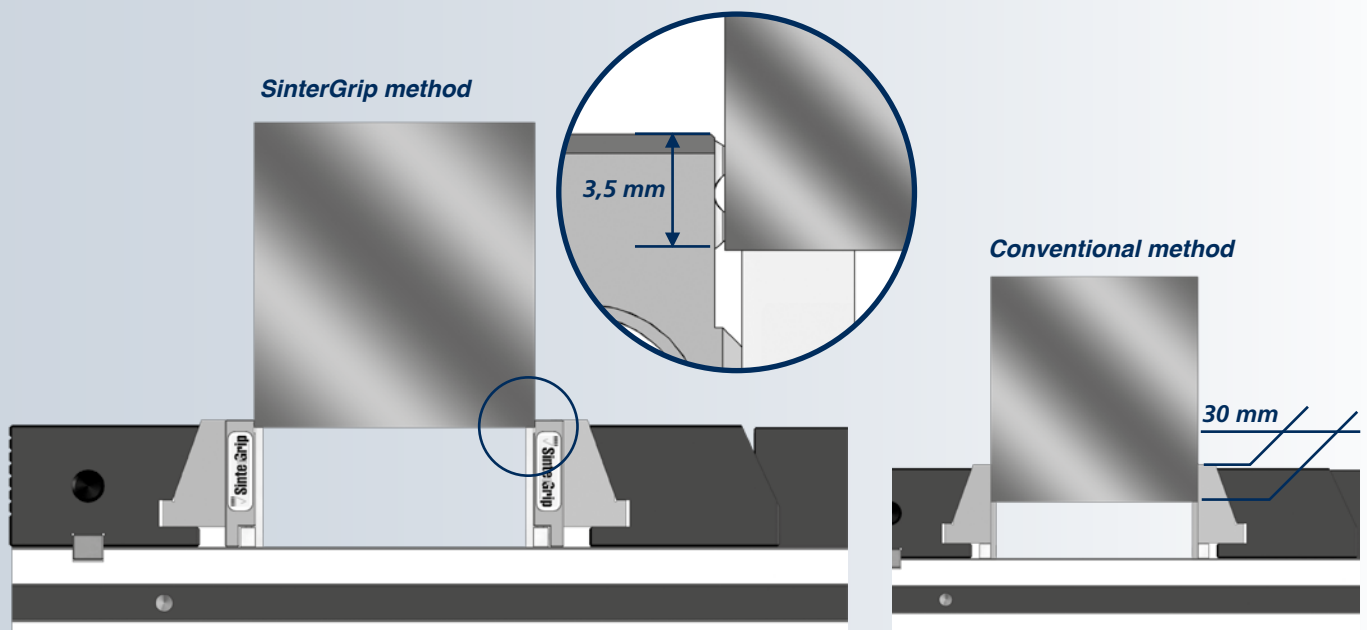

Only 3,5 mm clamping surface, no need of pre-machining the workpiece, clamping stability, higher cutting rate: **SinterGrip** brings only advantages compared to the traditional systems.

On the contrary, traditional systems need, for the clamping of the workpiece, a bigger clamping surface, with the result of waste of raw materials and greater possibility of deformation of the workpiece.

**GENIUS vise**

supplied with:

- Wrench
- Pair of positioning keys
- SinterGrip inserts for steel*
- Work stop

* on request SinterGrip inserts HRC or ALU

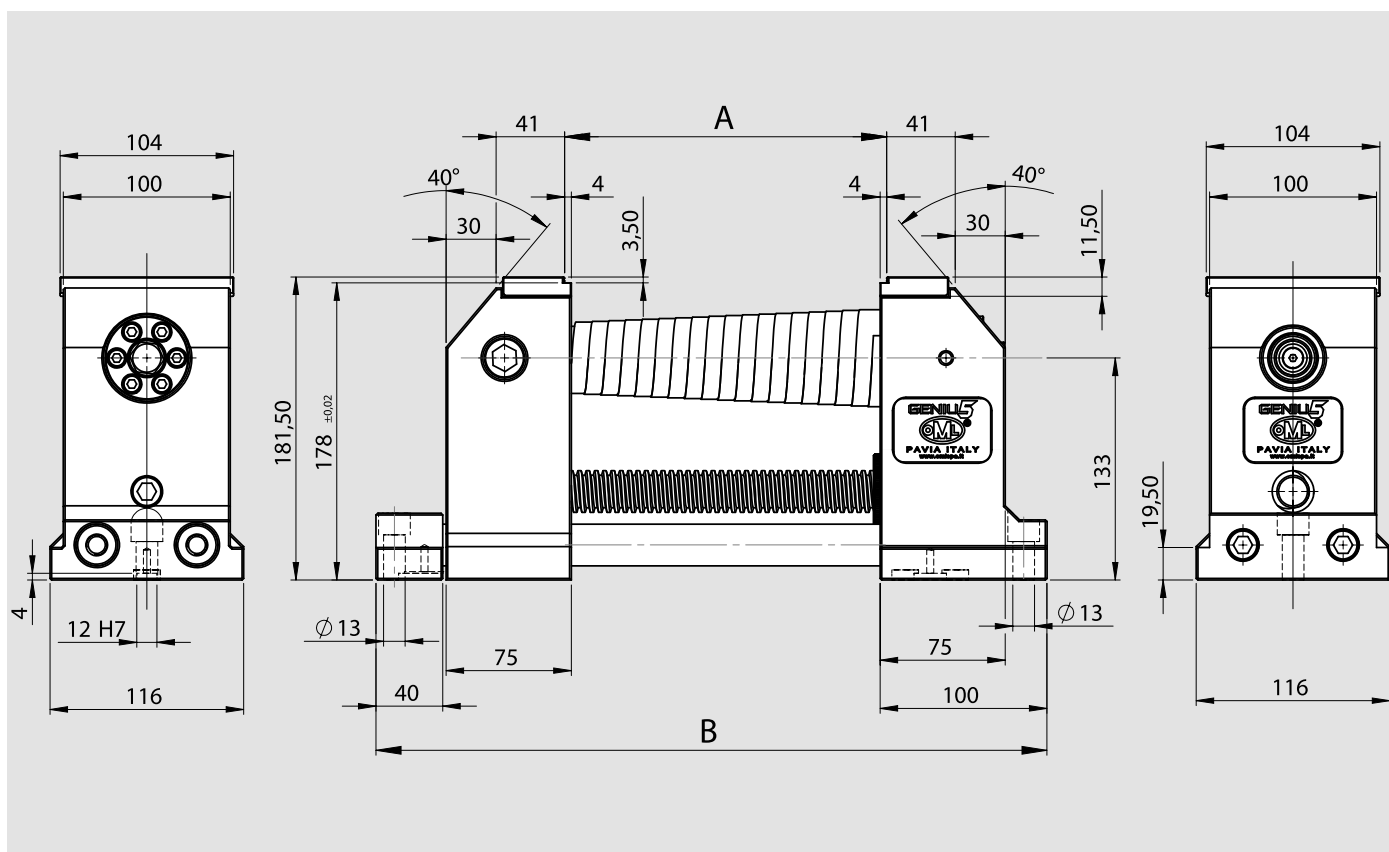

type	Id. No.	A*	B	Weight
GENIUS 100	77585011	100	321	23 Kg
GENIUS 200	77585012	200	412	25 Kg

* Special opening "A" upon request

Special applications upon request



WORK STOP

Id. No.

58505000



PAIR OF SMOOTH/GROOVED JAWS

Id. No.

58504119



PAIR OF CLAMPS

complete with screw and T-nuts

Id. No.

mm 12

mm 14

mm 16

mm 18

mm 20

mm 22

58022792

58022793

58022794

58022795

58022796

58022797

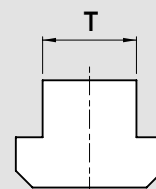

PAIR OF NUTS

complete with screws M12

Id. No.

T mm 14

T mm 16

T mm 18

T mm 20

T mm 22

58502593

58502594

58502595

58502596

58502597

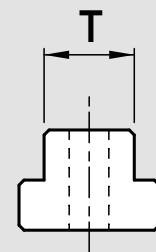

PAIR OF POSITIONING KEY

Id. No.

mm 12 h6

mm 14 h6

mm 16 h6

mm 18 h6

mm 20 h6

mm 22 h6

58011592

58011593

58011594

58011595

58011596

58011597

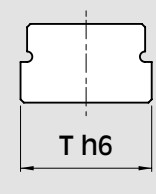

TORQUE WRENCH

Id. No.

51501006



SET OF 4 "GRIPPERS" H11 SMOOTH

Id. No.

58906114

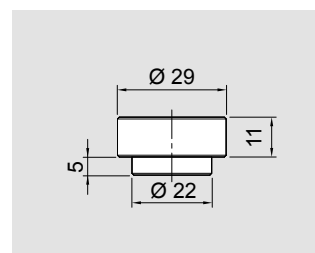

SET OF 4 "GRIPPERS" H11 SERRATED

Id. No.

58906124

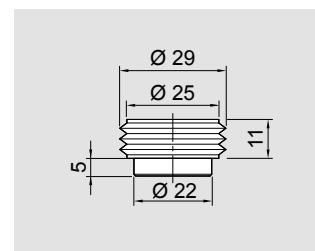

SET OF 4 "GRIPPERS" H19 SMOOTH

Id. No.

58906214

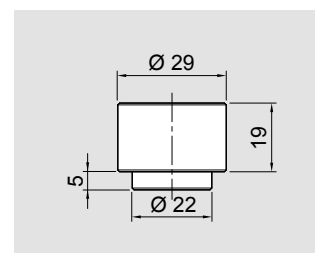

SET OF 4 "GRIPPERS" H19 SERRATED

Id. No.

58906224

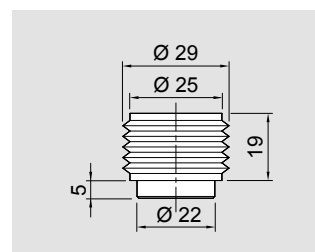

SET OF 4 "GRIPPERS" H24 SMOOTH

Id. No.

58906314

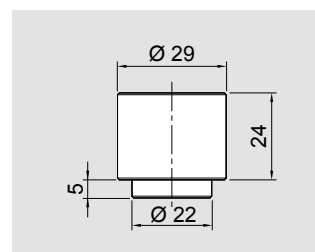

SET OF 4 "GRIPPERS" H24 SERRATED

Id. No.

58906324

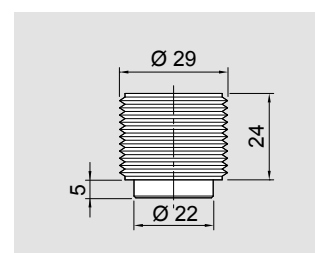

WORKING EXAMPLE WITH GRIPPERS



WORKING EXAMPLE WITH SINTERGRIP



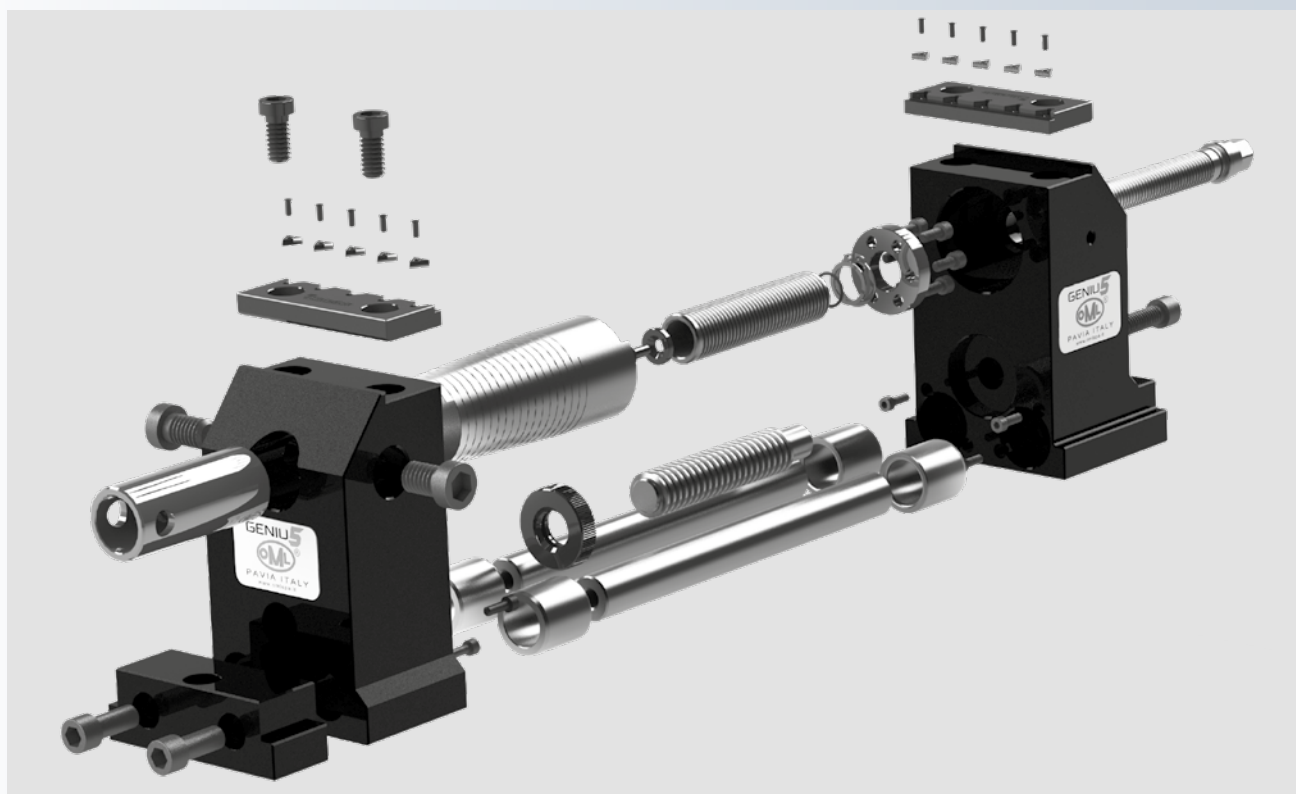
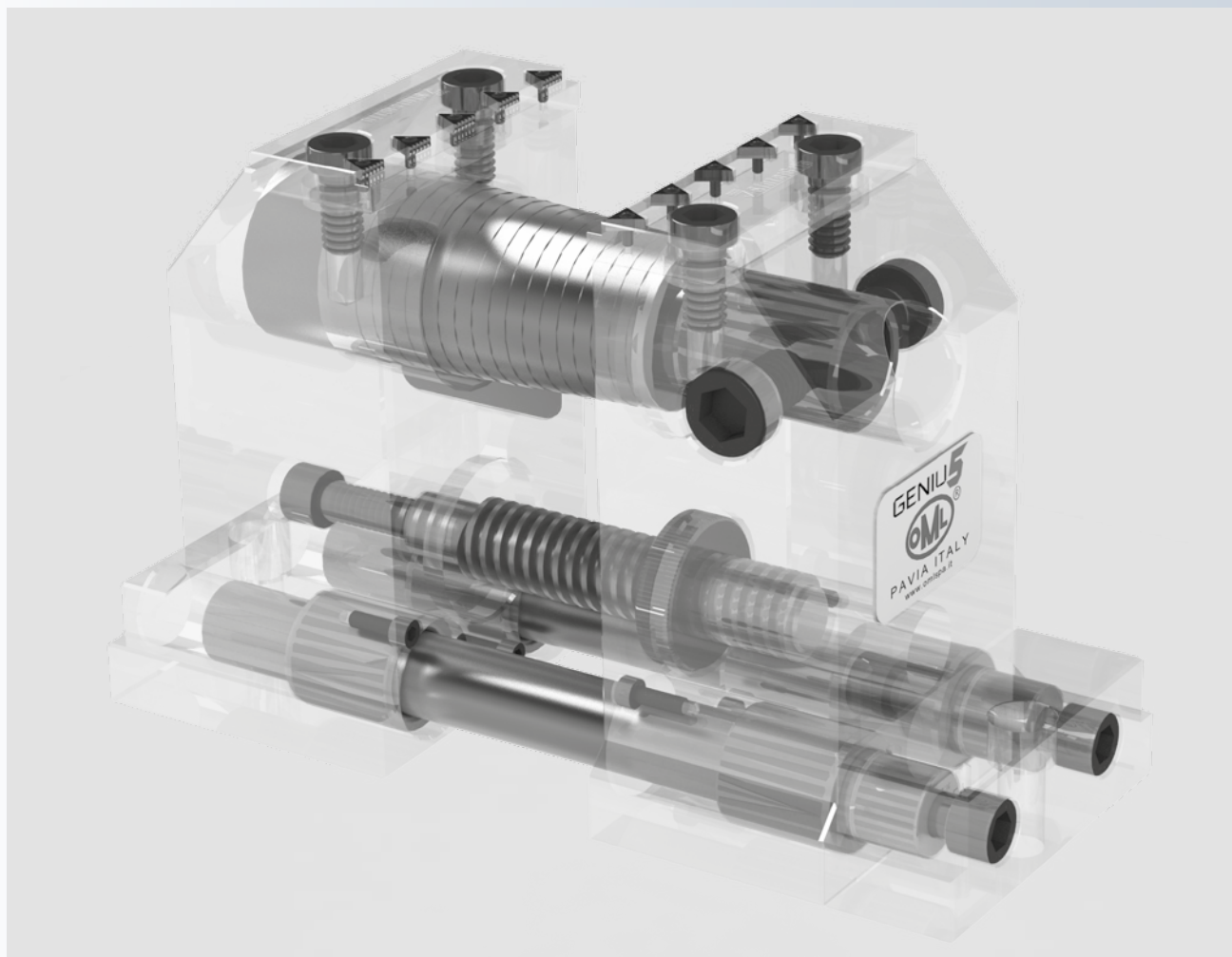



PAIR OF JAWS FOR SINTERGRIP

(SinterGrip inserts: see page S.17)

Id. No.

58451519



CLAMPING KEY

Id. No.

51502910

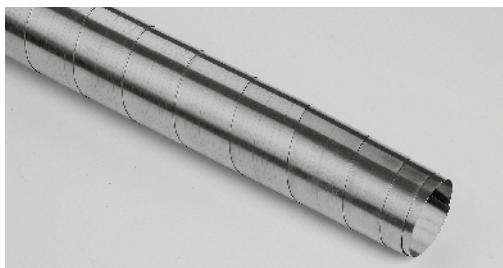

TELESCOPIC STAINLESS STEEL CARTER

Id. No.

71290218



SPINDLE GROUP

Id. No.

77585010

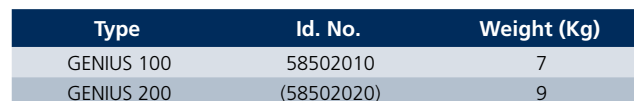

Id. No.					
mm 12	mm 14	mm 16	mm 18	mm 20	mm 22
58012792	58012793	58012794	58012795	58012796	58012797

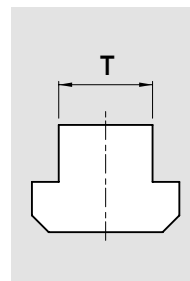

WORKING EXAMPLES



EN



A COMPANY OF THE GROUP



OFFICINA MECCANICA LOMBARDA S.r.l.

Viale dell'Industria 6 - 27020 Trivulzio (PV) ITALY
Tel. +39 0382 93 00 00

E-mail ► omlspa@omlspa.it

www.omlspa.it