



SERIE
TSI/TSX

FH

BAH

TA.CP

TA

MOX

HT

8-1

VH

TSI/TSX

T

MT-TC-TC3



Le teste multiple ad assi variabili serie TSI-TSX progettate a due mandrini paralleli o convergenti, sono adatte in lavorazioni di fresatura ed in particolare per la smussatura dei denti di ingranaggi.

Varie sono le caratteristiche tecniche delle teste multiple ad assi variabili serie TSI-TSX e sintetizzandone solamente alcune possiamo dire che:

- il corpo è in lega di alluminio;
- i supporti mandrino in ghisa e la loro regolazione avviene con un'unica azione dell'operatore;
- i mandrini possono ruotare concordi o discordi e la lubrificazione della testa è a grasso.

La loro realizzazione si è resa possibile in virtù dell'esperienza acquisita nella costruzione di teste multiple, della conoscenza dei processi produttivi e dalla capacità di saper proporre, per ogni particolare esigenza, prodotti qualificati.

The adjustable multispindle heads TSI and TSX series with two parallel or convergent spindles are suitable to mill and to chamfering the gear teeth. This is a solid, compact, reliable unit that also has a nice look.

The adjustable multispindle heads TSI and TSX series have many different features among which:

- an aluminum body;
- cast iron spindle support, simply and easily adjusted by the operator;
- the spindles may turn in the same direction or in opposite direction and the adjustment of both spindles is achieved thanks to a single act. The tool connection may be cylindrical or with spring collets. The lubrication is by long life grease.

The production of our twin adjustable multispindle head was made possible thanks to the experience acquired in the construction of multispindle heads, our knowledge of production process and our ability to know how to cater for individual requirements with qualified products.



TSI 1646

TESTA DI FRESATURA • TWIN SPINDLE MILLING HEAD



TSI 16-46C-P
TSI 16-46C-W

TSI 16-46D-P
TSI 16-46D-W



12 KG



12 KG



1-2



1-2



3000



3000

PESO
WEIGHT

ROTAZIONE
MANDRINI
SPINDLE
ROTATION

RAPPORTO
RATIO

GIRI MAX
RPM

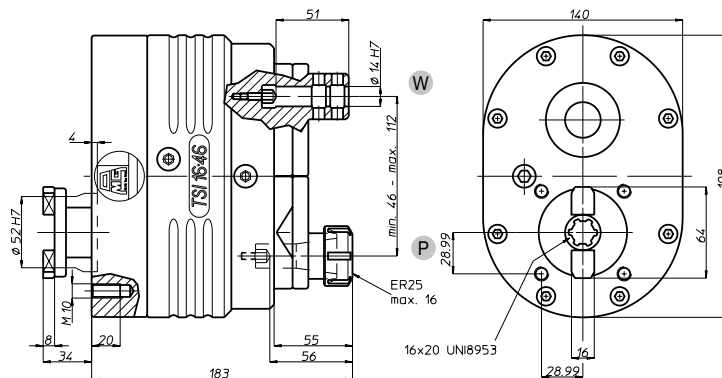

8-3

TSI 1681

TESTA DI FRESATURA • TWIN SPINDLE MILLING HEAD



TSI 16-81C-P
TSI 16-81C-W

TSI 16-81D-P
TSI 16-81D-W



13,5 KG



13,5 KG



1-2



1-2



3000



3000

PESO
WEIGHT

ROTAZIONE
MANDRINI
SPINDLE
ROTATION

RAPPORTO
RATIO

GIRI MAX
RPM

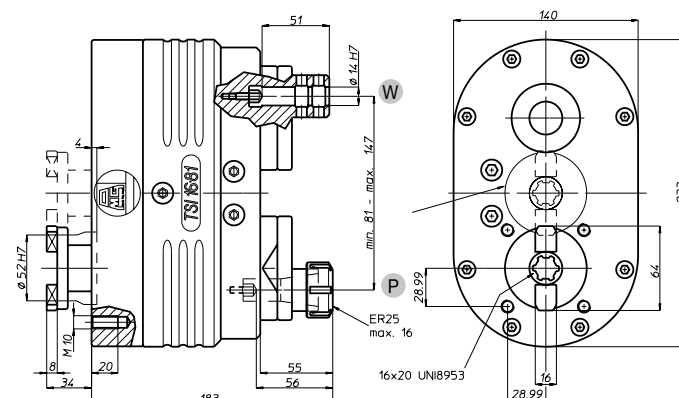

PESO
WEIGHT

ROTAZIONE
MANDRINI
SPINDLE
ROTATION

RAPPORTO
RATIO

GIRI MAX
RPM

TSI 16-180C-P
TSI 16-180C-W



22,5 KG



1-1



3000

TSI 16-180D-P
TSI 16-180D-W



22,5 KG



1-1



3000

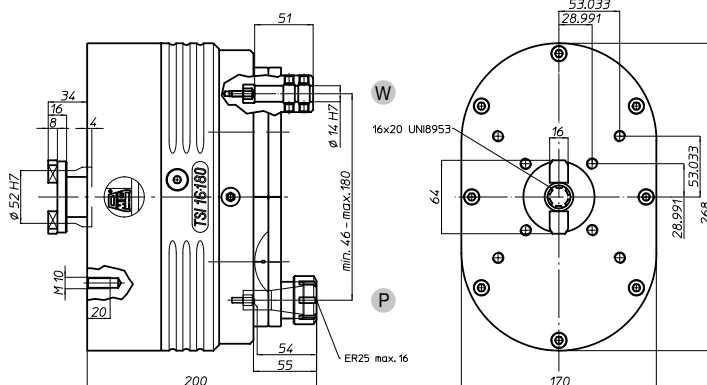

PESO
WEIGHT

ROTAZIONE
MANDRINI
SPINDLE
ROTATION

RAPPORTO
RATIO

GIRI MAX
RPM

TSI 16-210C-P
TSI 16-210C-W



22,5 KG



1-1



3000

TSI 16-210D-P
TSI 16-210D-W



22,5 KG



1-1



3000

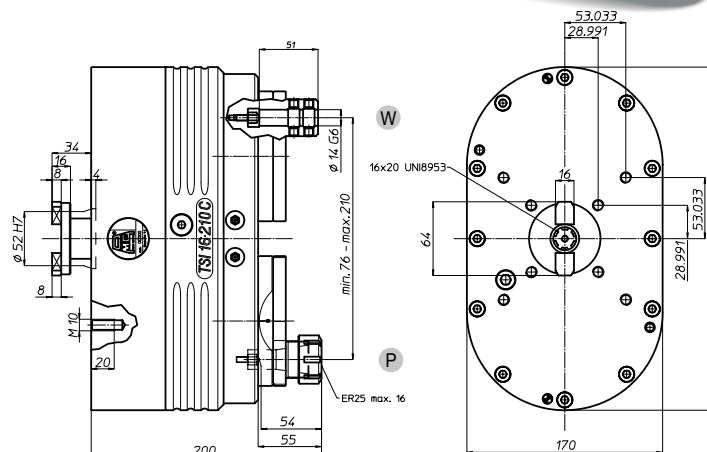

TSI 16180

TESTA DI FRESATURA - TWIN SPINDLE MILLING HEAD

FH

BAH

TA.CP

TA

MOX

HT

8-4

PESO
WEIGHT

ROTAZIONE
MANDRINI
SPINDLE
ROTATION

RAPPORTO
RATIO

GIRI MAX
RPM

TSI 16-210C-P
TSI 16-210C-W



22,5 KG



1-1



3000

TSI 16-210D-P
TSI 16-210D-W



22,5 KG



1-1



3000

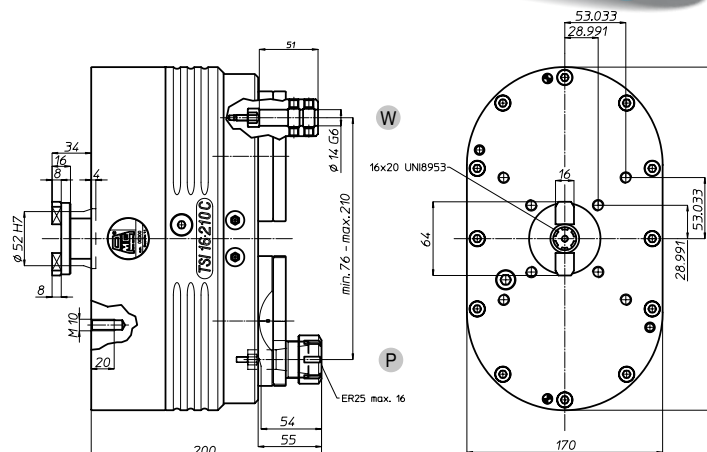

TSI 16210

TESTA DI FRESATURA - TWIN SPINDLE MILLING HEAD

VH

TSI/TSX

T

MT-TC-TC3



TSX13C

TESTA DI FRESATURA • TWIN SPINDLE MILLING HEAD

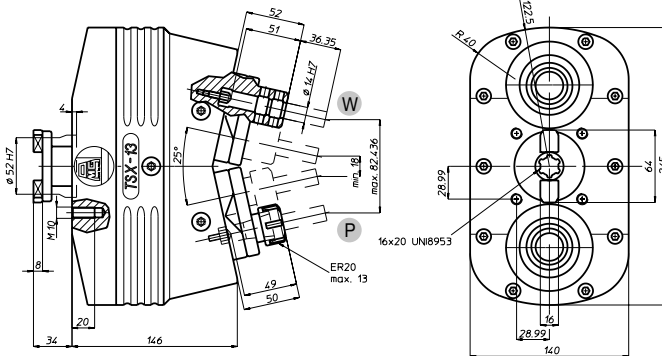

TSX 13C-P
TSX 13C-W



15,5 KG



1-1



3000

PESO
WEIGHT

ROTAZIONE
MANDRINI
SPINDLE
ROTATION

RAPPORTO
RATIO

GIRI MAX
RPM

8-5

TSX13D

TESTA DI FRESATURA • TWIN SPINDLE MILLING HEAD

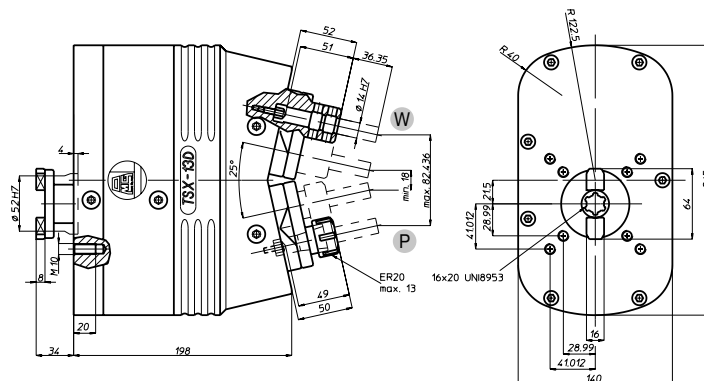

TSX 13D-P
TSX 13D-W



21 KG



1-1



3000

PESO
WEIGHT

ROTAZIONE
MANDRINI
SPINDLE
ROTATION

RAPPORTO
RATIO

GIRI MAX
RPM

PESO
WEIGHT

ROTAZIONE
MANDRINI
SPINDLE
ROTATION

RAPPORTO
RATIO

GIRI MAX
RPM

TSI 16-280C-P
TSI 16-280C-W



22,5 KG



1-1



3000

TSI 16-280D-P
TSI 16-280D-W



22,5 KG



1-1



3000

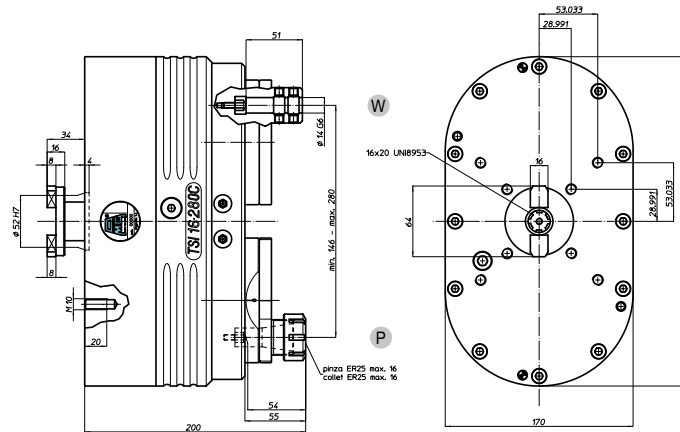

TSI 16280

TESTA DI FRESATURA - TWIN SPINDLE MILLING HEAD

FH

BAH

TA.CP

TA

MOX

HT

8-6

TFS 23801

Testa di spuntatura con
angolo di 34°
Fixed twin-spindle
milling head
with 34° from the axis



TS 31588

Testa di spuntatura ad assi
variabili, interasse min. 55
max 205,24
Adjustable twin multispindle
milling head, centre distance
min. 55 max 205,24



TFS 20205

Testa di spuntatura ad
assi sghembi, angolo
di 25°
Fixed twin-spindle
milling head
with skew axis at 25°



TFS 14005

Testa di spuntatura ad assi
fissi e paralleli, distanza
mm 40
Fixed twin-spindle milling
head, axis distance mm 40



ESECUZIONI SPECIALI
SPECIAL EXECUTIONS

VH

TSI/TSX

T

MT-TC-TC3

